

BEST New Wall Soundproofing Assembly

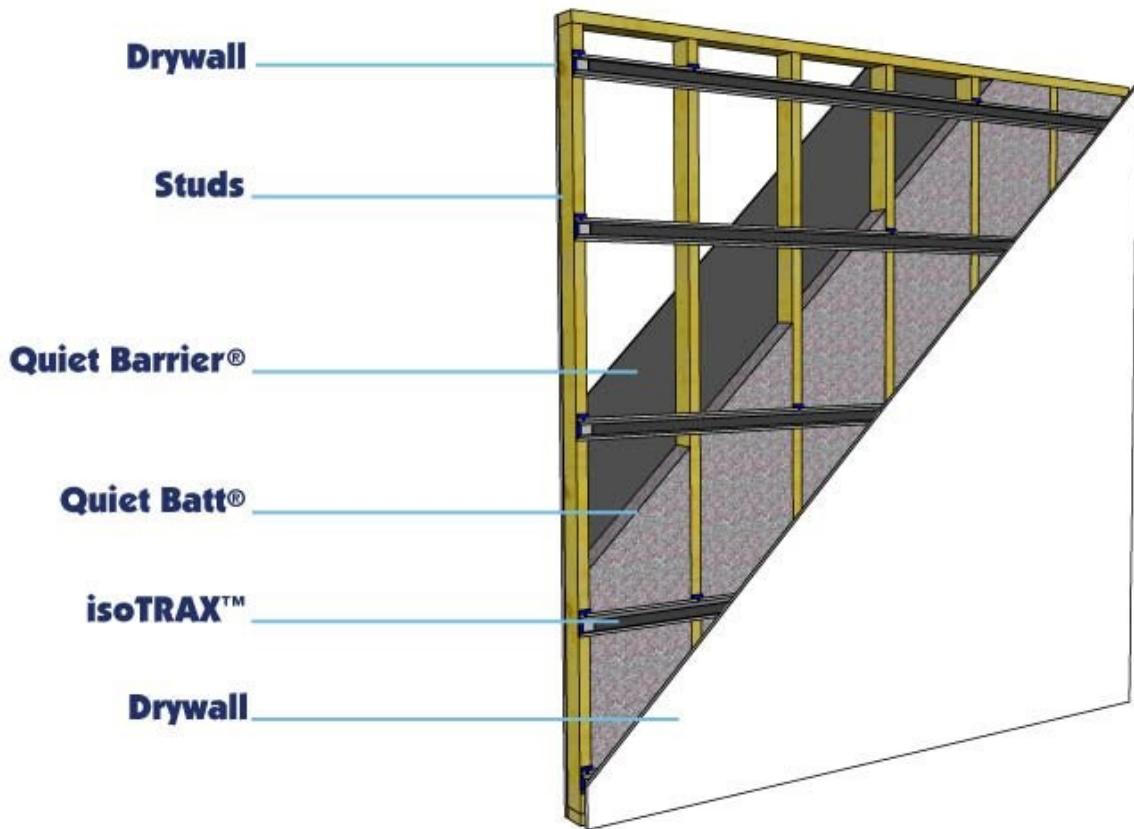

This is the best assembly for improving the soundproofing performance of newly constructed stud walls. Use this assembly to reduce airborne and structural borne noise transfer between two rooms. This type of construction is perfect for walls in home theaters, recording studios, walls adjacent to stairs/elevators and industrial machine rooms. This solution reduces low frequency noise from subwoofers and drums.

ADDRESS

Soundproofcow
440 Ramsey Avenue
Chambersburg, PA 17201

PHONE

P: 1-866-9499-COW
F: (717) 261-1790

WEB

www.soundproofcow.com



Products used in this assembly:

[isoTRAX™ Soundproofing System](#)



[Quiet Batt® Soundproofing Insulation](#)



[Quiet Barrier® Soundproofing Material](#)



[Quiet Barrier® Tape](#)



[OSI® Pro-Series® SC-175™ Acoustical Sound Sealant](#)



ADDRESS

Soundproofcow
440 Ramsey Avenue
Chambersburg, PA 17201

PHONE

P: 1-866-9499-COW
F: (717) 261-1790

WEB

www.soundproofcow.com



Instructions / Details

1. On one side of the wall, install the Quiet Barrier® HD onto the studs with 1 ¼ inch roofing nails. Butt the edges of the Quiet Barrier® HD tightly together. Try to minimize the amount of seams.
2. Peel and place the Quiet Barrier® Tape over all of the seams of the Quiet Barrier®.
3. Install 5/8 inch Type X gypsum board with 1 5/8 inch coarse thread drywall screws. Screws should be placed 8 to 12 inches apart. Leave a ¼ inch gap between the new layer of gypsum board and all adjoining wall, ceiling and floor surfaces.
4. Install the Quiet Batt between the studs.
5. On the other side of the wall, install the isoTRAX™ Soundproofing System on to the studs.
6. Install 5/8 inch Type X gypsum board on to the isoTRAX™ system with 1 ¼ inch fine thread drywall screws. Screws should be placed 12 inches apart. Leave a ¼ inch gap between the new layer of gypsum board and all adjoining wall, ceiling and floor surfaces.
7. Fill the ¼ inch gap with OSI® Pro-Series® SC-175™ Acoustical Sound Sealant.
8. Finish the gypsum board using common industry standards.

Note: For increased performance add another layer of 5/8 inch Type X Gypsum board.

ADDRESS

Soundproofcow
440 Ramsey Avenue
Chambersburg, PA 17201

PHONE

P: 1-866-9499-COW
F: (717) 261-1790

WEB

www.soundproofcow.com

