

## BEST Existing Wall Soundproofing Assembly

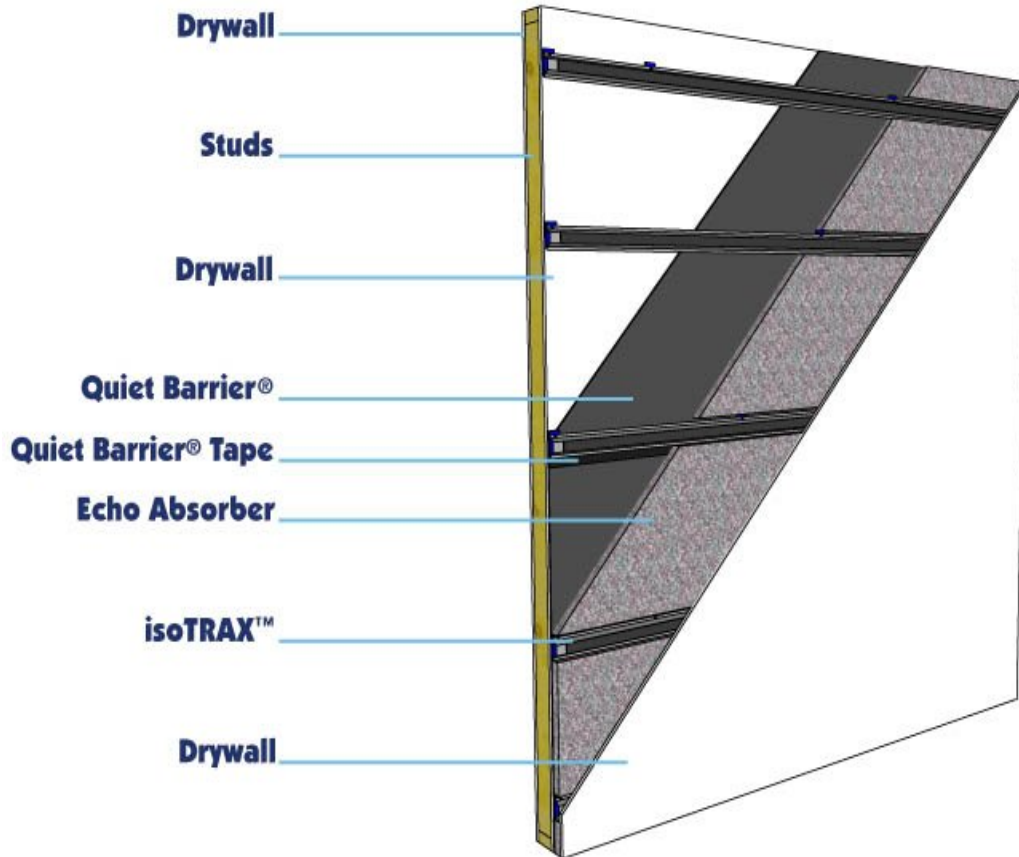

This is the best assembly for improving the soundproofing performance of an existing wall. Use this assembly to reduce airborne and structural borne noise transfer between to rooms. This type of construction is perfect for retro fitting existing walls in home theaters, recording studios, walls adjacent to stairs/elevators and industrial machine rooms. This solution reduces low frequency noise from subwoofers and drums.

### ADDRESS

Soundproofcow  
440 Ramsey Avenue  
Chambersburg, PA 17201

### PHONE

P: 1-866-9499-COW  
F: (717) 261-1790

### WEB

[www.soundproofcow.com](http://www.soundproofcow.com)



## Products used in this assembly:

[isoTRAX™ Soundproofing System](#)



[Echo Absorber™ Acoustic Panel](#)

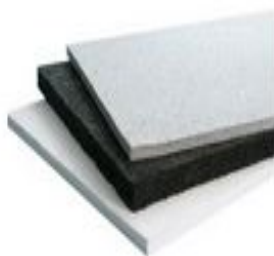

[Quiet Barrier® Soundproofing Material](#)



[Quiet Barrier® Tape](#)



[OSI® Pro-Series® SC-175™ Acoustical Sound Sealant](#)



### ADDRESS

Soundproofcow  
440 Ramsey Avenue  
Chambersburg, PA 17201

### PHONE

P: 1-866-9499-COW  
F: (717) 261-1790

### WEB

[www.soundproofcow.com](http://www.soundproofcow.com)



## Instructions / Details

---

1. Use a stud finder to locate the studs within the wall. Mark the studs with a chalk line.
2. Install the Quiet Barrier® HD onto the wall surface with 1 ¼ inch roofing nails. Butt the edges of the Quiet Barrier® HD tightly together. Try to minimize the amount of seams.
3. Peel and place the Quiet Barrier® Tape over all of the seams of the Quiet Barrier®.
4. Install the isoTRAX Soundproofing System over the barrier layer.
5. Install the Echo Absorber Acoustic Panels between the isoTRAX™ rails.
6. Install 5/8 inch Type X gypsum board on to the isoTRAX™ system with 1 ¼ inch fine thread drywall screws. Screws should be placed 12 inches apart. Leave a ¼ inch gap between the new layer of gypsum board and all adjoining wall, ceiling and floor surfaces.
7. Fill the ¼ inch gap with OSI® Pro-Series® SC-175™ Acoustical Sound Sealant. Finish the gypsum board using common industry standards.

**Note:** For increased performance add another layer of 5/8 inch Type X Gypsum board.

---

### ADDRESS

Soundproofcow  
440 Ramsey Avenue  
Chambersburg, PA 17201

### PHONE

P: 1-866-9499-COW  
F: (717) 261-1790

### WEB

[www.soundproofcow.com](http://www.soundproofcow.com)

